



CMR 351

SPARE PARTS LIST



1. Spare parts list

Pos.	Code	Description	Type (*)	Quantity
1		Angle Adjustment Sleeve		2
2		Hex Bolt M6x30		2
3		Nut M6		4
4		45° Support Bracket	S	2
5		Washer 10X30X3		4
6		Angle Adjustment Lock Knob/M10x25	S	2
7		Rear Support Post	S	1
8		Nut M8		8
9		Hex Bolt M8x30		6
10		Wrench Storage	S	1
11		Hex Head Bolt M5x10		2
12		Length Stop(Long)	S	1
13		Cutting Head Travel Bumper	S	2
14		Screw M5x16		2
15		Inner Hex Bolt M6x20		8
16		Guide Bar	S	1
17		Hex Bolt M8x25 with Flange		8
18		Multipurpose Wrench	S	1
19		Washer 6		11
20		Lock Washer 6		6
21		Hex Bolt M6x16		9
22		Guide Rail	W	1
23		Cable & Hose Hanger	S	1
24		Plug Seat	S	1
25		Nylon Plain Washer 22x10.5x2		2
26		Front Support Post	S	1
27		Spring Clip		1
28		Washer 5		4
29		Lock Washer 5		1
30		Hex Bolt M5x12		2
31		Length Stop(Short)	S	1
32		Water Collection	S	1
33		Ruler Guide	W	1
34		Inner Hex Screw M8x10		2
35		Carry Handle	S	4
36		Carry Handle Sleeve	S	4
37		Hex Bolt M8x25		3
38		Lock Washer 8		6
39		Sleeve	S	2
40		Shaft	S	2
41		Screw M5x10		4
42		Starlike Knob M10x25	S	10
43		Main Metal Frame	S	1
44		Cutting Table A	S	1
45		Spring Clip	S	2
46		Cutting Table B	S	1
47		Drain Plug	S	2
48		Screw M8x25 with Spring & Ball		4

49		Plastic Protection Cap		1
50		Hex Bolt M4x8		4
51		Cutting Head Position Bracket	S	1
52		Starlike Knob M6x35	S	1
53		Push Handle	S	1
54		Rubber Handle	S	3
55		Starlike Knob M6x10	S	2
56		Hex Bolt M10x180		1
57		Washer 10		4
58		Adjustment Locking Handle	S	1
59		Load Spring	S	1
60		Nylon lock Nut M10		1
61		Hex Bolt M10x20		1
62		Nut M10		1
63		Screw M4x45		4
64	310370255	Switch	W	1
65		Washer 8X30X3		5
66		Hex Bolt M8x20		2
67		Washer 8		8
68		Motor Bracket	S	1
69		Diamond Blade		1
70		Flat Washer 5X15		1
71		Nut M5		1
72		Splash Guard	W	1
73		Inner Blade Guard	S	1
74		Ouer Blade Guard	S	1
75		Hose Ø 18X2.5 L=3.4m	W	1
76		Water Valve	W	1
77		Adapter	W	1
78		"O" Ring 16X2.4		1
79		"Y" Adapter	W	1
80		Hose Ø 8X1.5 L=3.2m	W	1
81		Hose Ø 8X1.5 L=3.2m	W	1
82		Straight Leg	S	4
83		Rubber Pad	W	4
84		Butterfly Screw M6x12		2
85		Plastic Hanlde	S	1
86		Guide A Cut	W	1
87		Screw M6x20		2
88	310064856	Guide A Cut 45°	W	1
90	310377102	Water Pump	W	1
C		Cutting Head Carriage Bracket Complete Set	S	1
C-1		Nut M8		8
C-2		Adjustment Guide Wheel Shaft(Short)	S	4
C-3		Bearing 6201-2RS		17
C-4		Sleeve	S	4
C-5		Inner Hex Screw M8x45		6
C-6		Thin Nut M8		6
C-7		Rolling Wheel Shaft	S	1
C-8		Washer 8		6
C-9		Lock Washer 8		6
C-10		Rolling Wheel Shaft(Short)	S	3

C-11		Adjustment Guide Wheel Shaft(Long)	S	2
C-12		Hex Bolt M8x115		2
C-13		Cutting Head Carriage Bracket	S	1
M	310047701	Motor 230V	S	1
M-1		Lock Nut / M20(Left)		1
M-2	310048258	Outer Flange	S	1
M-3	310048257	Inner Flange	S	1
M-4		Key 5x10		1
M-5		Shaft Seal $\Phi 47 \times \Phi 25 \times 12$		1
M-6		Screw M5x25		10
M-7		Split Lock Washer 5		12
M-8		Flat Washer 5		10
M-9		Front Cover	S	1
M-10		Bearing 6205		1
M-11		Rotor	S	1
M-12		Bearing 6202		1
M-13		Stator	S	1
M-14		Motor Housing	S	1
M-15		End Cover	S	1
M-16	310064557	Fan	S	1
M-17	310060598	Fan Cover	S	1
M-18		Cord Grip(PG9)		1
M-19		Cord Grip(PG13.5)		1
M-20		Screw M5x16		4
M-21		Capacitor Cover	S	1
M-22		Rubber Seal	S	1
M-23	310370870	Capacitor	S	1
M-24		Capacitor Retainer	S	2
M-25		Screw M4x10		1
M-26		Flat Washer 4		1
M-28		Wiring Block	S	1
S	310384549	Side Extension Table Complete Set	S	1
S-1		Hex Bolt M8x16		2
S-2		Split Lock Washer 8		2
S-3		Flat Washer 8		2
S-4		Ruler Guide on Side Extension Table	W	1
S-5		Butterfly Screw M6x12		2
S-6		Flat Washer 6		2
S-7		Mounting Plate	S	1
S-8		Side Extension Table	S	1

(*): S = Spare part, W = Wear part

Wear parts are worn out through normal use of the machine. The wear period depends a lot on the intensity of use of the machine. Wear parts must be serviced, used and eventually changed following the indications of the manufacturer. Any wear due to normal use of the machine will not be considered as a case of warranty. Genuine CLIPPER replacement parts should always be used.

2. Exploded views

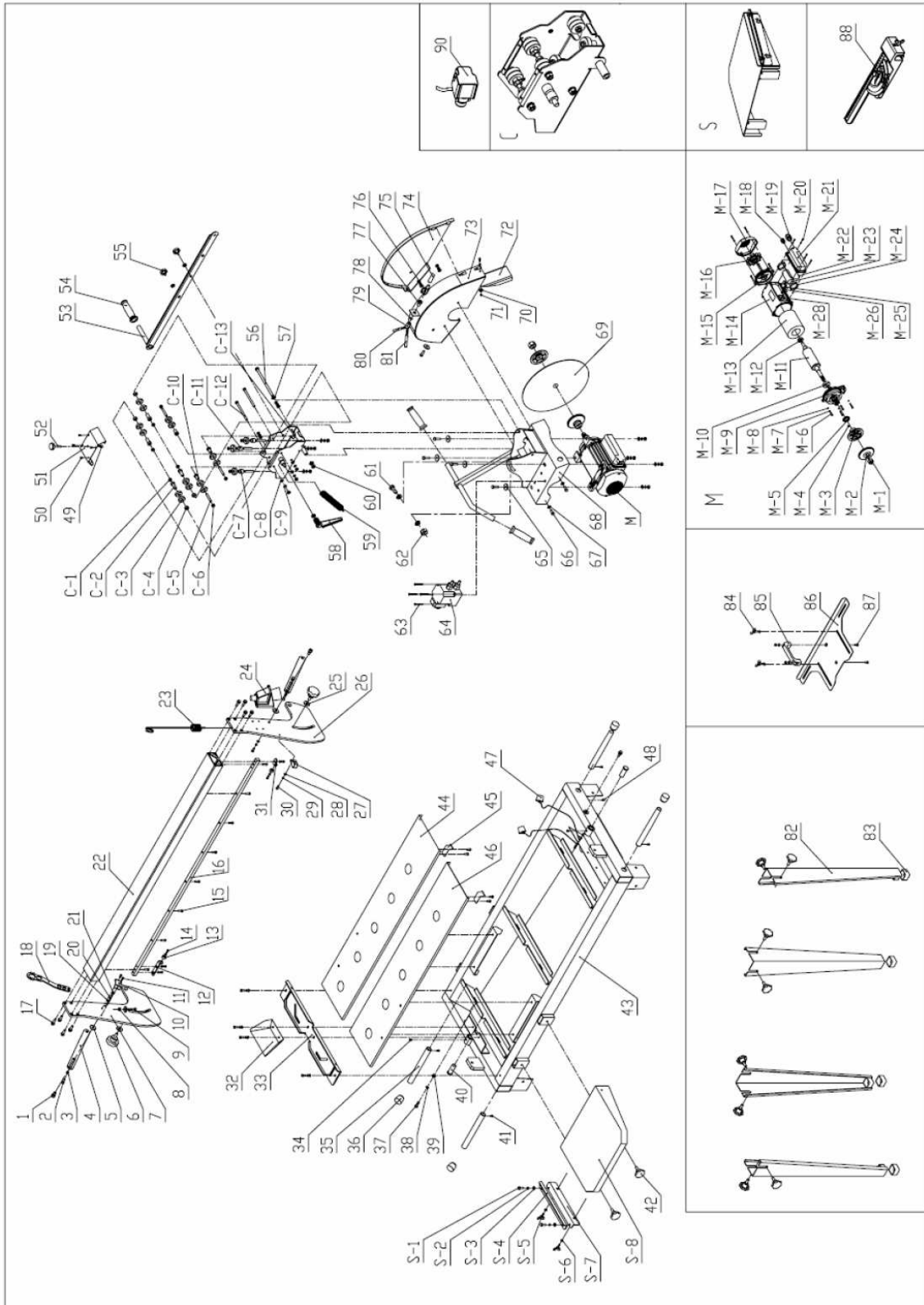



SAINT-GOBAIN ABRASIVES

190, Bd. J. F. Kennedy
L-4930 BASCHARAGE
LUXEMBOURG

Tel.: ++352 50401-1

Fax: ++352 501633

e-mail: sales.nlx@saint-gobain.com

www.construction.norton.eu

05.05.09